

Assembly instructions

IN012 IN013 Illuminated Double Expodesk



The package content:

- A. Bag containing the structure: 1 pcs.
- B. Bag containing the rods: 10 straight rods, 6 convex rods, 4 concave rods, 4 semicircle rods.
- C. Bag containing one countertop and two shelves: 1 pcs.
- D. Tube containing the personalisation and lighting system: 1 pcs.

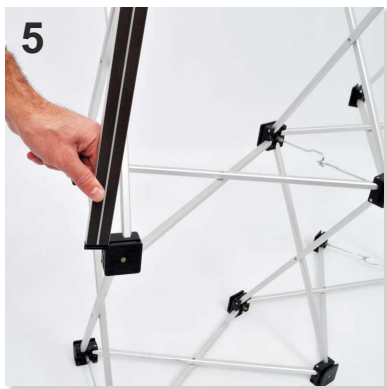
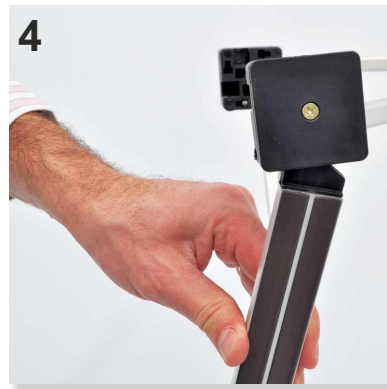
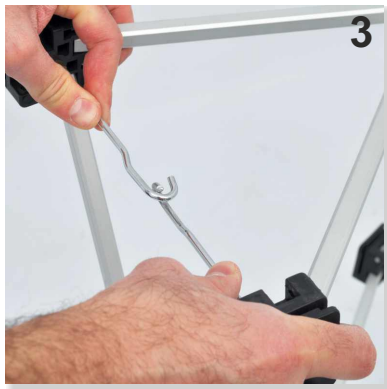
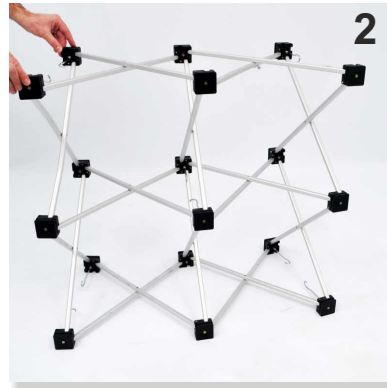

The pictures are for presentation purposes only. Your product may be slightly different.

Assembly instructions

IN012 IN013 Illuminated Double Expodesk



7. Mount the six convex rods in a horizontal position at the front, as in picture.

8. Mount the four concave rods in horizontal position, in the back and front side. The four semicircle rods will be positioned on the sides of the structure at the top and bottom.



9. Place the shelves in the middle of the structure, as in the picture.

10-11. Add the personalisation starting from the back to the front D, continuing to the back, as in the image.



12. We attach the lighting system on structure, inserting it into the 2 clips as in the picture.

13. Unfold the C countertop and position it above the structure. Insert the four pegs located under the countertop into the holes in the black plastic squares. Being a flexible structure, you may need to extend the structure a little to fit all the pegs in their slot.



Now the expodesk is assembled. To move the desk, it is advisable to grab it from the back of the structure.

The pictures are for presentation purposes only. Your product may be slightly different.